

MODEL ; R&K-AA390-RS

SPECIFICATIONS

Frequency Range	; 500 – 4000MHz
Small Signal Gain	; +23dB (typ.) @3GHz ; +20dB (min.)
Gain Flatness	; ±2.0dB (max.)
Output Power@1dB Comp.	; +26dBm (min.) @3GHz
Output I.C.P.	; +39dBm (typ.) @3GHz
Noise Figure	; 10.0dB (max.)
Impedance	; 50 Ω
Input VSWR	; 1.5 : 1 (typ.)
Output VSWR	; 2.5 : 1 (typ.)
AC Supply Input	; AC100 ~ 240V / 50 ~ 60Hz ; 30VA (max.)
Maximum RF Input Power	; +11dBm
Operating Temperature	; -15°C to +45°C
Storage Temperature	; -15°C to +65°C
Connectors (In/Out)	; SMA-FEMALE
Weight	; 3.0kg (max.)

OUTLINE DRAWING

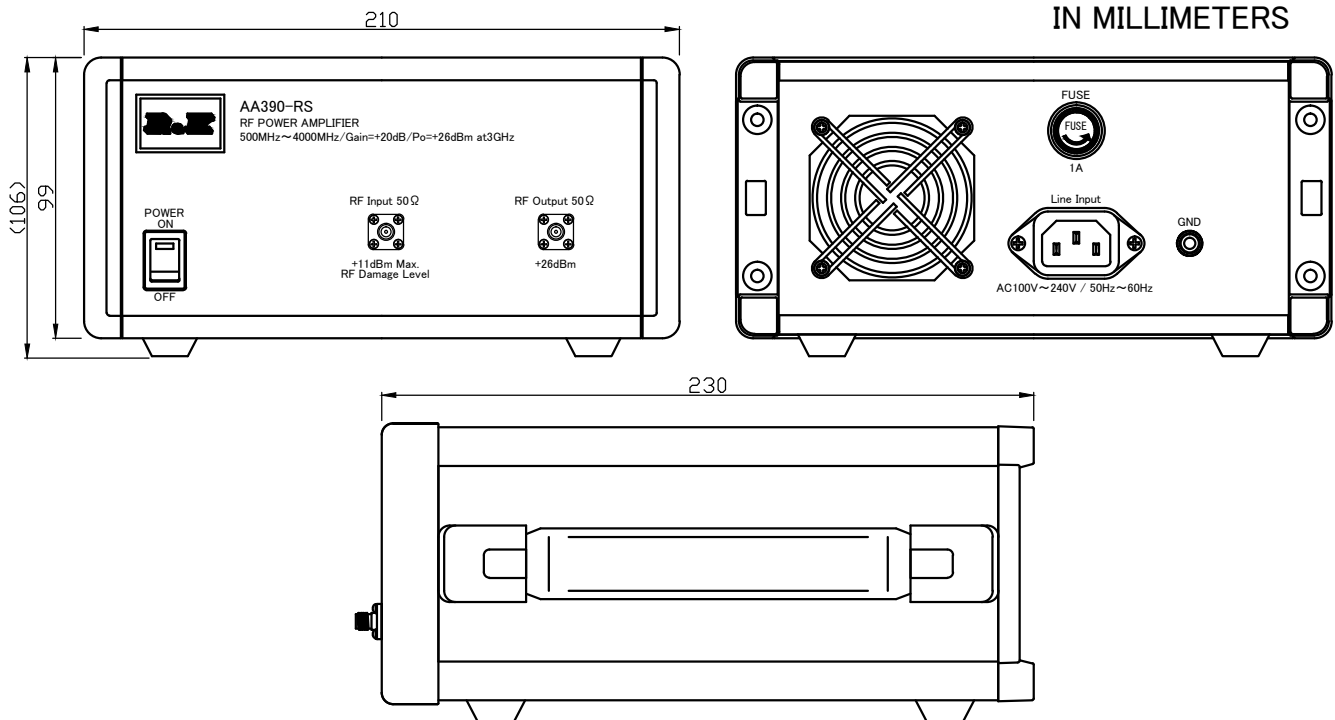

NOTE ; Specifications subject to change without notice.

2016/3/3 図面番号修整
EK-20-0235-X-00 → EK-20-0239-X-00
2018/10/16 Spec. Change

		株式会社 アルアンドケー	
		縮尺 SCALE	単位 UNIT
三 角 法	1/	mm inch	作成年月日 DRAWN
検認 APPROVED	照査 CHECKED	設計 DESIGNED	作成 DRAWN
Masahiko Suzuki	Susumu Tomotaka	Yuya Mochizuki	Yuya Mochizuki

AA390-RS

仕様書

EK-20-0239-3-00