

# MODEL ; R&K-AA300-RS

## SPECIFICATIONS

Frequency Range	; 0.2 – 300MHz
Small Signal Gain	; +34dB (typ.) @100MHz ; +33dB (min.)
Gain Flatness	; ±1.5dB (max.)
Output Power@1dB Comp.	; +35dBm (min.) @100MHz
Output I.C.P.	; +46dBm (typ.) @100MHz
Noise Figure	; 9.0dB (max.)
Impedance	; 50 Ω
Input VSWR	; 1.5 : 1 (typ.)
Output VSWR	; 3.0 : 1 (typ.)
AC Supply Input	; AC100V 50/60Hz ; 0.4A (max.)
Maximum RF Input Power	; +7dBm
Operating Temperature	; -15°C to +45°C
Storage Temperature	; -15°C to +65°C
Connectors (In/Out)	; SMA-FEMALE
Weight	; 3.0kg (max.)

## OUTLINE DRAWING

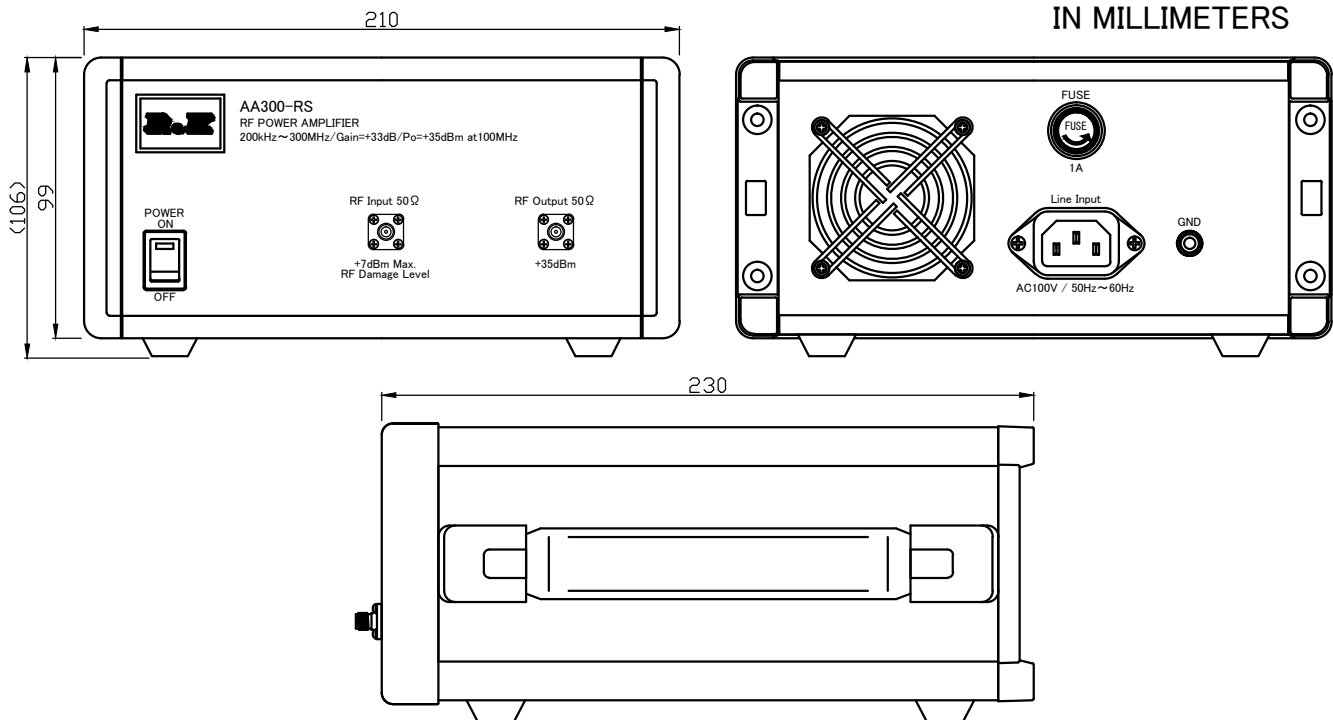

NOTE ; Specifications subject to change without notice.

2018/10/16 Spec. Change

		株式会社 アルアンドケー	
三 角 法	縮尺 SCALE	単位 UNIT	作成年月日 DRAWN
	/	mm inch	2009/11/5
検認 APPROVED	照査 CHECKED	設計 DESIGNED	作成 DRAWN
Masahiko Suzuki	Tomotaka	Masahiko Suzuki	Takano

AA300-RS

仕様書

EK-20-0230-3-00